

**CITY OF CASTLE PINES
RESOLUTION NO. 21-03**

**A RESOLUTION OF THE CITY COUNCIL OF THE CITY OF CASTLE PINES,
COLORADO APPROVING THE CASTLE PINES PARKWAY, I-25 TO LAGAE ROAD
LANDSCAPE PLAN**

WHEREAS, the City Council has authorized City staff to engage a consultant, DTJ Design, to prepare a Castle Pines Parkway, I-25 to Lagae Road Landscape Plan (“Plan”) for the Castle Pines community; and

WHEREAS, the goal of the Plan is to provide a cohesive landscape design for the gateway of the City west of I-25 along Castle Pines Parkway; and

WHEREAS, the Plan will assist the City Council in prioritizing future streetscape improvements which will require future budget appropriations within the City’s available funding sources; and

WHEREAS, City Council desires to approve the Plan, a copy of which is available at the City offices and on the City’s website.

NOW, THEREFORE, BE IT RESOLVED BY THE CITY COUNCIL OF THE CITY OF CASTLE PINES, COLORADO:

Section 1. The City Council hereby approves the Castle Pines Parkway, I-25 to Lagae Road Landscape Plan, dated February 5, 2021, subject to the addition of potential cost estimates for logical segments to aid in Council planning for future appropriations; and directs City staff to include cost estimates in the Plan and to publish such document on the City’s website.

Section 2. This Resolution is effective upon adoption.

**INTRODUCED, READ AND ADOPTED AT A REGULAR MEETING OF THE
CITY COUNCIL OF THE CITY OF CASTLE PINES, COLORADO** by a vote of 6 in favor, 1 against this 26th day of January, 2021.



ATTEST:

DocuSigned by:
Tobi Basile
AD03A3B02032499...
Tobi Basile, City Clerk

BY: DocuSigned by:
Tera Stave Radloff
6E0C8EB279DC479...
Tera Stave Radloff, Mayor

Approved as to form:
DocuSigned by:
Linda C. Michow
5241DE99B8FF444...
Linda C. Michow, City Attorney

© 2021 dtj DESIGN. ALL RIGHTS RESERVED. DTJ-2021-001



CITY OF CASTLE PINES |

FEBRUARY 5, 2021

CASTLE PINES PARKWAY

I-25 TO LAGAE ROAD LANDSCAPE PLAN

Organization - The Big Idea



Organized
[formal at intersections, nodes, entrances]



Organic
[naturally flowing stretches between major nodes]

Concept A - Pine Rows



Concept B - Tiered Walls



Concept C - Hybrid



NOT FOR REGULATION, APPROVAL, PERMITTING, OR CONSTRUCTION



Castle Pines Parkway
City of Castle Pines

CastlePines Parkway ID: TR2017031404-01-000-02000000000007

Concept C - Hybrid



NOT FOR REGULATORY APPROVAL, PERMITTING, OR CONSTRUCTION



Castle Pines Parkway
City of Castle Pines

Concept C - Hybrid



NOT FOR REGULATORY, APPLICANT, PERMITTING, OR CONSTRUCTION.



Castle Pines Parkway
City of Castle Pines



Concept C - Hybrid



NOT FOR REGULATORY APPROVAL. PRELIMINARY. IN CONSULTATION.



Castle Pines Parkway
City of Castle Pines

Concept C - Hybrid



Concept C - Hybrid



NOT FOR REGULATORY APPROVAL, PERMITTING, OR CONSTRUCTION.



Castle Pines Parkway
City of Castle Pines

Previous Council Comments - 10/13/20

- 1 Snow Tolerance of the design - resistance to mag chloride / ice / snow piling.
- 2 Concerns about west side of city looking old & outdated while east side of city looks new & flashy.
- 3 Concerns about sight lines; spacing between monumentation and roads / walkways.
- 4 Castle Pines is subject to a tremendous amount of microclimates, wind conditions, and other factors. The planting design needs to respond to these local elements, be exclusively native zone 4 plants, and have consideration to cost of maintenance.

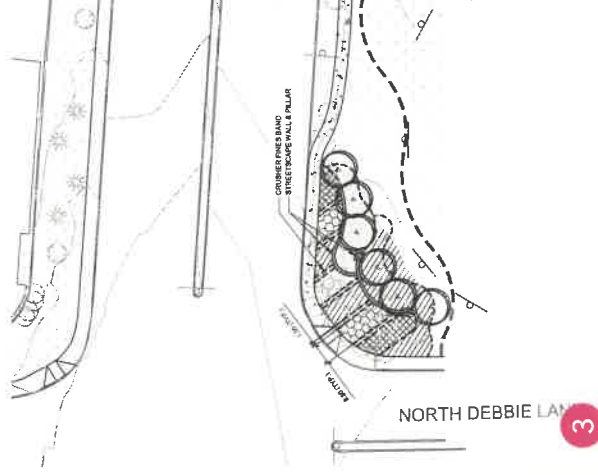

Planting Palette

- Native Palette with low-water use / low-maintenance cost, in line with Castle Pines North Metro District suggestions
- Tolerant of all urban / street conditions
- Year-round Seasonal Interest
- Planting that stands out as a community
- Create a unique identity as guests and residents enter Castle Pines
- Accent local businesses and entities



Simplistic overstory selections
with native evergreen, deciduous, and ornamental variety

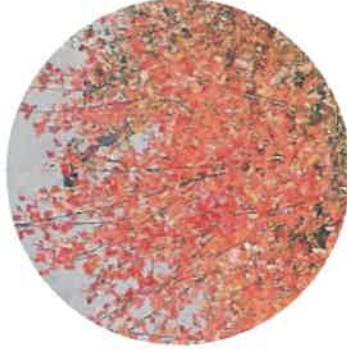

Tough native shrub selections
with variety of seasonal color to act as a backdrop to showy plants



Evergreen shrubs & groundcovers
for winter interest and to compliment the rugged rock style of monumentation elements

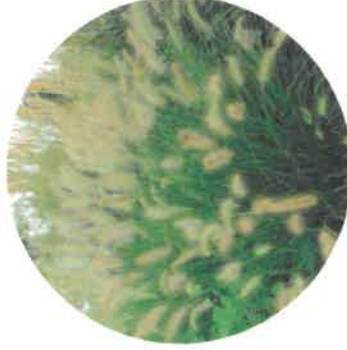

Native ornamental grasses
to compliment shrub/perennial plantings and for height variety adjacent to monumentation

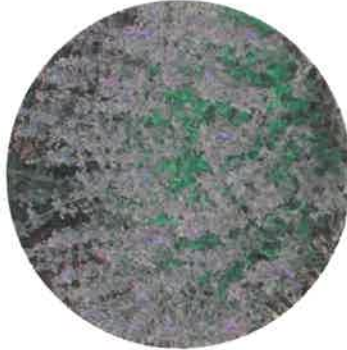

Perennial plant mixture
tolerant of adjacent road conditions as a thriving plant community

Planting Palette

CASTLE PINES GATEWAY OVERSTORY SCHEDULE

KEY	Scientific Name	Common Name	Size (min)	Height	Spread	Light	Water Use	Notes
DECIDUOUS TREES								
AG	<i>Acer grandidentatum</i>	Big Tooth Maple	2 1/2" cal.	10'-30'	20'-30'	Full sun, Partial shade	Low	native; tolerant of many soils
CO	<i>Celtis occidentalis</i>	Western Hackberry	2 1/2" cal.	40'-60'	50'	Full Sun	Low	xeric tree; highly adaptable to adverse conditions, good street tree
EVERGREEN TREES								
JS	<i>Juniperus scopulorum</i>	Rocky Mountain Juniper	6'-12' ht.	20'-30'	8'-12'	Full Sun	Low	good windbreak; pyramidal, bluish-green; drought tolerant
PS	<i>Pinus strobiformis</i>	Southwestern White Pine	6'-12' ht.	40'-50'	20'-30'	Full Sun	Low	tolerates heat and wind, will thrive in variety of soil conditions
ORNAMENTAL TREES								
MAP	<i>Malus x 'Prairiefire'</i>	Prairiefire Crabapple	2" cal.	20'	20'	Full Sun	Low	four season ornamental interest, deep red color with spectacular pink blooms

CASTLE PINES GATEWAY UNDERSTORY SCHEDULE

KEY	Scientific Name	Common Name	Size (min)	Height	Spread	Light	Water Use	Notes
DECIDUOUS SHRUBS								
CM	<i>Chamaebatia millefolium</i>	Fernbush	1 gal.	4'	4'	Full Sun	Low	semi-evergreen, showy white blooms through summer, winter interest
PLC	<i>Philadelphus lewisii</i> 'Cheyenne'	Cheyenne Mockorange	5 gal.	5'-8'	5'-8'	Full Sun	Low	native; tough, beautiful shrub
PB	<i>Prunus besseyi</i> 'Pawnee Buttes'	Pawnee Buttes Sandcherry	1 gal.	18"	4'	Full Sun	Low	attractive and reliable; great native bee plant
RT	<i>Rhus trilobata</i>	Three Leaf Sumac	5 gal.	6'	6'	Full Sun	Low	high habitat value, use in masses; brilliant fall foliage
EVERGREEN SHRUBS								
CN	<i>Chrysothamnus nauseosus</i> var. <i>nauseosus</i>	Baby Blue Rabbitbrush	1 gal.	24"	24"	Full sun, Partial shade	Low - Xeric	seasonal interest, wind resistant
PNM	<i>Pinus mugo</i> 'Slow Mound'	Dwarf Mountain Pine	1 gal.	12"-36"	36"	Full Sun	Low	
PMH	<i>Pinus sylvestris</i> 'Hillside Creeper'	Hillside Creeper Scotch Pine	1 gal.	24"-36"	7'-8"	Full Sun	Low	winter interest; low maintenance, thrives in all soils and tolerant of urban pollution
YS	<i>Yucca glauca</i>	Soapweed	1 gal.	2'-3'	2'-3'	Full Sun	Low	native
ORNAMENTAL GRASSES								
AC	<i>Pennisetum alopecuroides</i> 'Hamel'	Dwarf Fountain Grass	1 gal.	24"-36"	24"	Full Sun	Low	effective mass planting, beautiful color variety over seasons, tolerates soils
PVN	<i>Schizachyrium scoparium</i> 'Prairie Blues'	Little Bluestem 'Prairie Blues'	1 gal.	48"	30"	Full Sun	Low - Xeric	
PERENNIALS / GROUNDCOVERS								
AXC	<i>Archostaphylos x coloradoensis</i>	Panchito Manzanita	1 gal.	12"-15"	24"-36"	Full sun, Partial shade	Low - Xeric	native broadleaf evergreen groundcover, winter interest
AF	<i>Artemisia frigida</i>	Prairie Sagewort	1 gal.	24"	24"	Full Sun	Low	native; silver foliage
CP	<i>Ceratostigma plumbaginoides</i>	Plumbago	1 gal.	12"	24"	Full sun, Partial shade	Low	
EP	<i>Echinacea purpurea</i>	Purple Coneflower	1 gal.	24"	24"	Full Sun	Low	effective for mass groundcover, rocks, erosion control; good border plant in front of taller shrubs
JHM	<i>Juniperus horizontalis</i> 'Mother Lode'	'Mother Lode' Juniper	1 gal.	4"	8'-10'	Full Sun	Low / Mod	
NF	<i>Nepeta x faassenii</i>	Catmint	1 gal.	24"	24"	Full Sun	Low	
RH	<i>Rudbeckia hirta</i>	Black Eyed Susan	1 gal.	36"-42"	24"	Full Sun	Low	

NOTES:
1. Final plant selections pending per availability and final soil testing.

NOT FOR REGULATORY APPROVAL. PERMITTING OR CONSTRUCTION.



Castle Pines Parkway
City of Castle Pines

I-25 TO LAGAE ROAD LANDSCAPE PLAN
planting palette

February 5, 2021

Planting Palette at Monumentation



Dwarf Fountain Grass
Pennisetum alopecuroides 'Hameln'



Hillside Creeper Scotch Pine
Pinus sylvestris 'Hillside Creeper'



Catmint
Nepeta x faassenii



Prairie Sagewort
Artemisia frigida



Hackberry
Celtis occidentalis



Baby Blue Rabbitbrush
Chrysothamnus nauseosus



'Mother Lode' Juniper
Juniperus horizontalis 'Mother Lode'



Purple Coneflower
Echinacea purpurea



Prairiefire Crabapple
Malus x 'Prairiefire'



Southwestern White Pine
Pinus strobiformis

NOT FOR REGULATORY APPROVAL, PERMITTING, OR CONSTRUCTION



Castle Pines Parkway
City of Castle Pines

Schematic Design

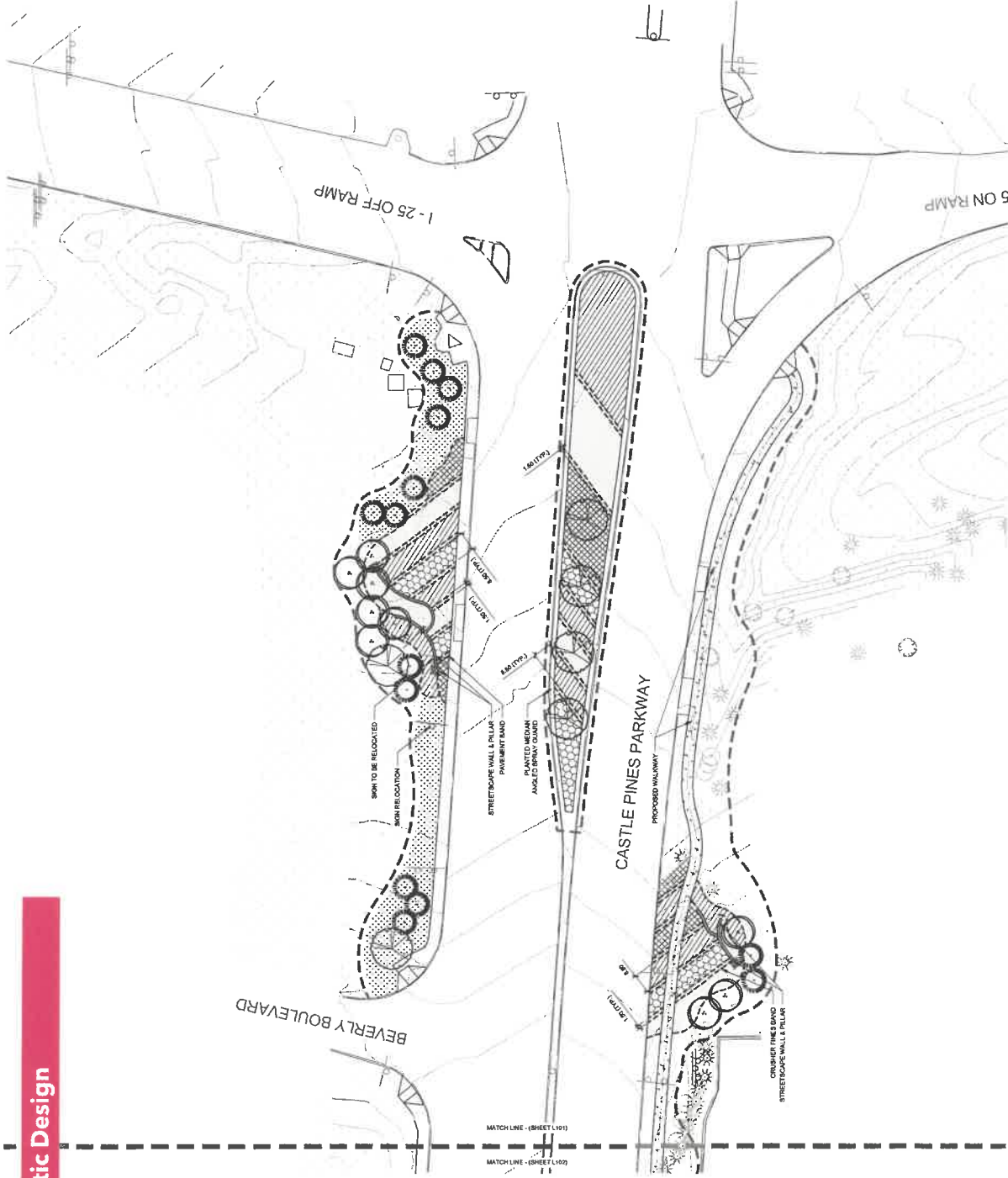

LAYOUT & GRADING LEGEND

[Symbol]	LIMIT OF WORK
[Symbol]	PROPERTY BOUNDARY
[Symbol]	STEEL LEADER
[Symbol]	LOT LINES
[Symbol]	EASEMENT LINE
[Symbol]	MATCHLINE (SEE KEY MAP)
[Symbol]	CONCRETE WALK
[Symbol]	CRUISER FINES
[Symbol]	LANDSCAPE WALL
[Symbol]	MONUMENT PILLAR

LANDSCAPE LEGEND

[Symbol]	EVERGREEN SHRUB
[Symbol]	DECIDUOUS SHRUB
[Symbol]	ORNAMENTAL GRASS
[Symbol]	PERENNIAL & GROUNDCOVER
[Symbol]	MANICURED TURF
[Symbol]	EXISTING TREES & SHRUBS
[Symbol]	PROPOSED TREES (CIRCUMFERENCE ONLY, EVD)

NOTE: SEE LANDSCAPE GENERAL NOTES SHEET FOR A LIST OF ABBREVIATIONS

BY OTHERS - N.I.C.

[Symbol]	FIRE HYDRANT
[Symbol]	AREA INLET / DRAINAGE
[Symbol]	EXISTING 1" CONTOUR
[Symbol]	EXISTING 5" CONTOUR
[Symbol]	WATER VALVE
[Symbol]	TELEPHONE LINE
[Symbol]	ELECTRICAL LINE
[Symbol]	STOP LIGHT
[Symbol]	SIGN
[Symbol]	TREE LIGHT
[Symbol]	CONCRETE PAD
[Symbol]	SEWER MANHOLE
[Symbol]	MANHOLE
[Symbol]	EXISTING ELECTRICAL UTILITIES

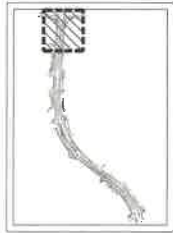

I-25 TO LAGAE ROAD LANDSCAPE PLAN

Schematic Design

LAYOUT & GRADING LEGEND	
	LIMIT OF WORK
	PROPERTY BOUNDARY
	STEEL EDDGER
	LOT LINES
	EASEMENT LINE
	MATCHLINE (SEE KEY MAP)
	CONCRETE WALK
	CRUSHER FINES
	LANDSCAPE WALL
	MONUMENT PILLAR
LANDSCAPE LEGEND	
	EVERGREEN SHRUB
	DECIDUOUS SHRUB
	ORNAMENTAL GRASS
	PERENNIAL & GROUND COVER
	MANICURED TURF
	EXISTING TREES & SHRUBS
	PROPOSED TREES (DECIDUOUS OR A D.V.)

BY OTHERS - N.I.C.	
	FIRE HYDRANT
	AREA INLET/ DRAINAGE
	EXISTING 7' CONTOUR
	WATER VALVE
	TELEPHONE LINE
	ELECTRICAL LINE
	STOP LIGHT
	SIGN
	STREET LIGHT
	CONCRETE PAD
	SEWER MANHOLE
	MANHOLE
	EXISTING ELECTRICAL UTILITIES

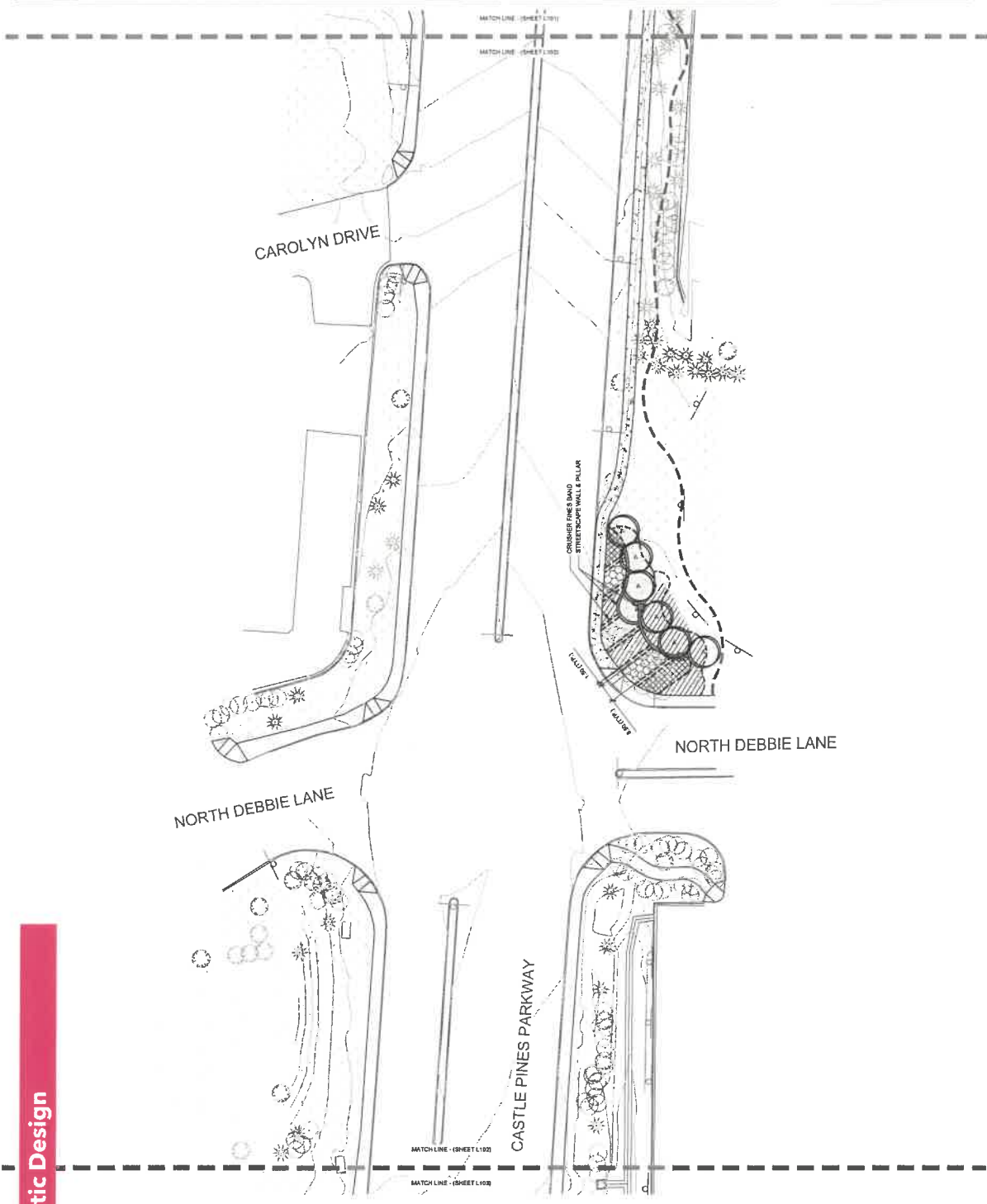

KEYMAP

NOT FOR REGULATORY APPROVAL PERMITTING OR CONSTRUCTION.

Schematic Design

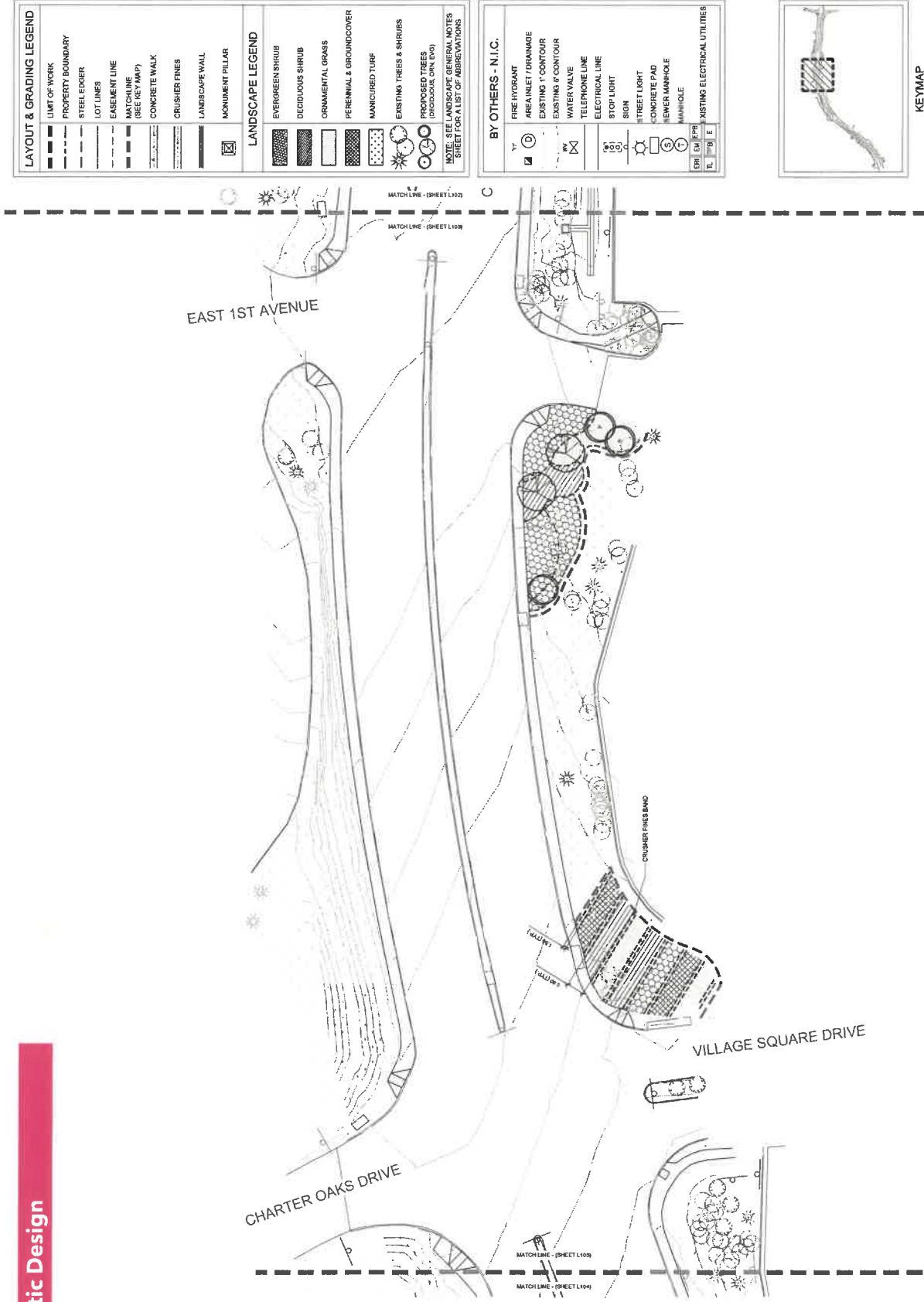

LAYOUT & GRADING LEGEND	
[Symbol]	LIMIT OF WORK
[Symbol]	PROPERTY BOUNDARY
[Symbol]	STEEL EDCOR
[Symbol]	LOT LINES
[Symbol]	EASEMENT LINE
[Symbol]	MATCHLINE (SEE KEY MAP)
[Symbol]	CONCRETE WALK
[Symbol]	CRUSHER FINES
[Symbol]	LANDSCAPE WALL
[Symbol]	MONUMENT PILLAR

LANDSCAPE LEGEND	
[Symbol]	EVERGREEN SHRUB
[Symbol]	DECIDUOUS SHRUB
[Symbol]	ORNAMENTAL GRASS
[Symbol]	PERENNIAL & GROUNDCOVER
[Symbol]	MANICURED TURF
[Symbol]	EXISTING TREES & SHRUBS
[Symbol]	PROPOSED TREES (ORCHARDIA ORN. ETC)

NOTE: SEE LANDSCAPE GENERAL NOTES SHEET FOR A LIST OF ABBREVIATIONS

BY OTHERS - N.I.C.	
[Symbol]	FIRE HYDRANT
[Symbol]	AREA INLET / DRAINAGE
[Symbol]	EXISTING 1" CONTOUR
[Symbol]	EXISTING 5" CONTOUR
[Symbol]	WATER VALVE
[Symbol]	TELEPHONE LINE
[Symbol]	ELECTRICAL LINE
[Symbol]	STOP LIGHT
[Symbol]	SIGN
[Symbol]	STREET LIGHT
[Symbol]	CONCRETE PAD
[Symbol]	SEWER MANHOLE
[Symbol]	MANHOLE
[Symbol]	EXISTING ELECTRICAL UTILITIES

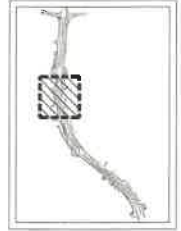

NOT FOR REGULATORY APPROVAL. PERMITTING FOR CONSTRUCTION.



Castle Pines Parkway
City of Castle Pines

I-25 TO LAGAE ROAD LANDSCAPE PLAN

Schematic Design

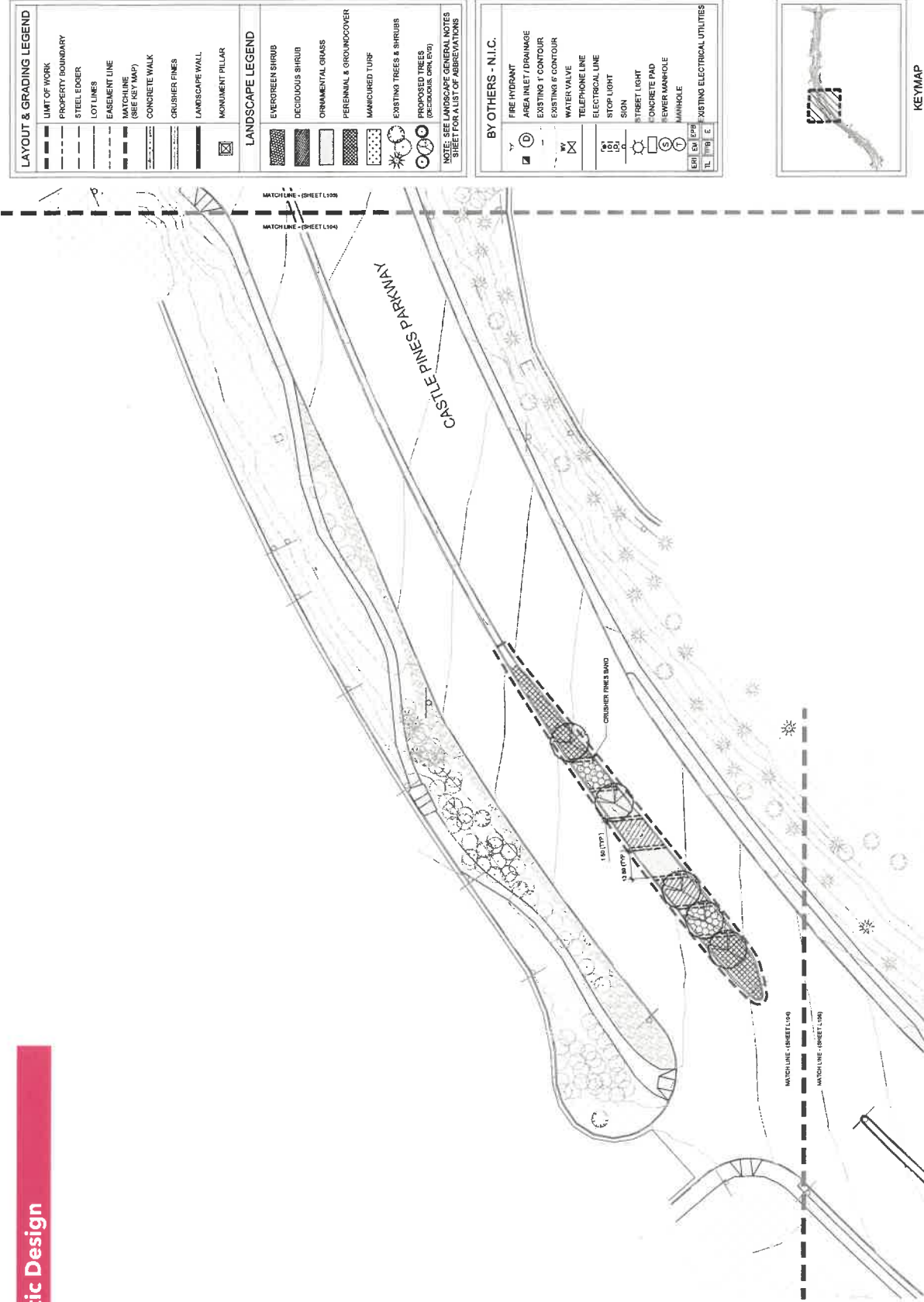

LAYOUT & GRADING LEGEND

[Symbol]	LIMIT OF WORK
[Symbol]	PROPERTY BOUNDARY
[Symbol]	STEEL LEDGER
[Symbol]	LOT LINES
[Symbol]	EASEMENT LINE
[Symbol]	MATCHLINE (SEE KEY MAP)
[Symbol]	CONCRETE WALK
[Symbol]	CRUSHER FINES
[Symbol]	LANDSCAPE WALL
[Symbol]	MONUMENT PILLAR

LANDSCAPE LEGEND

[Symbol]	EVERGREEN SHRUB
[Symbol]	DECIDUOUS SHRUB
[Symbol]	ORNAMENTAL GRASS
[Symbol]	PERENNIAL & GROUNDCOVER
[Symbol]	MANICURED TURF
[Symbol]	EXISTING TREES & SHRUBS
[Symbol]	PROPOSED TREES (DECIDUOUS ORN. ETC.)

NOTE: SEE LANDSCAPE GENERAL NOTES SHEET FOR A LIST OF ABBREVIATIONS

BY OTHERS - N.I.C.

[Symbol]	FIRE HYDRANT
[Symbol]	AREA INLET / DRAINAGE
[Symbol]	EXISTING 1' CONTOUR
[Symbol]	EXISTING 6' CONTOUR
[Symbol]	WATER VALVE
[Symbol]	TELEPHONE LINE
[Symbol]	ELECTRICAL LINE
[Symbol]	STOP LIGHT
[Symbol]	SIGN
[Symbol]	STREET LIGHT
[Symbol]	CONCRETE PAD
[Symbol]	SEWER MANHOLE
[Symbol]	MANHOLE
[Symbol]	EXISTING ELECTRICAL UTILITIES



Schematic Design

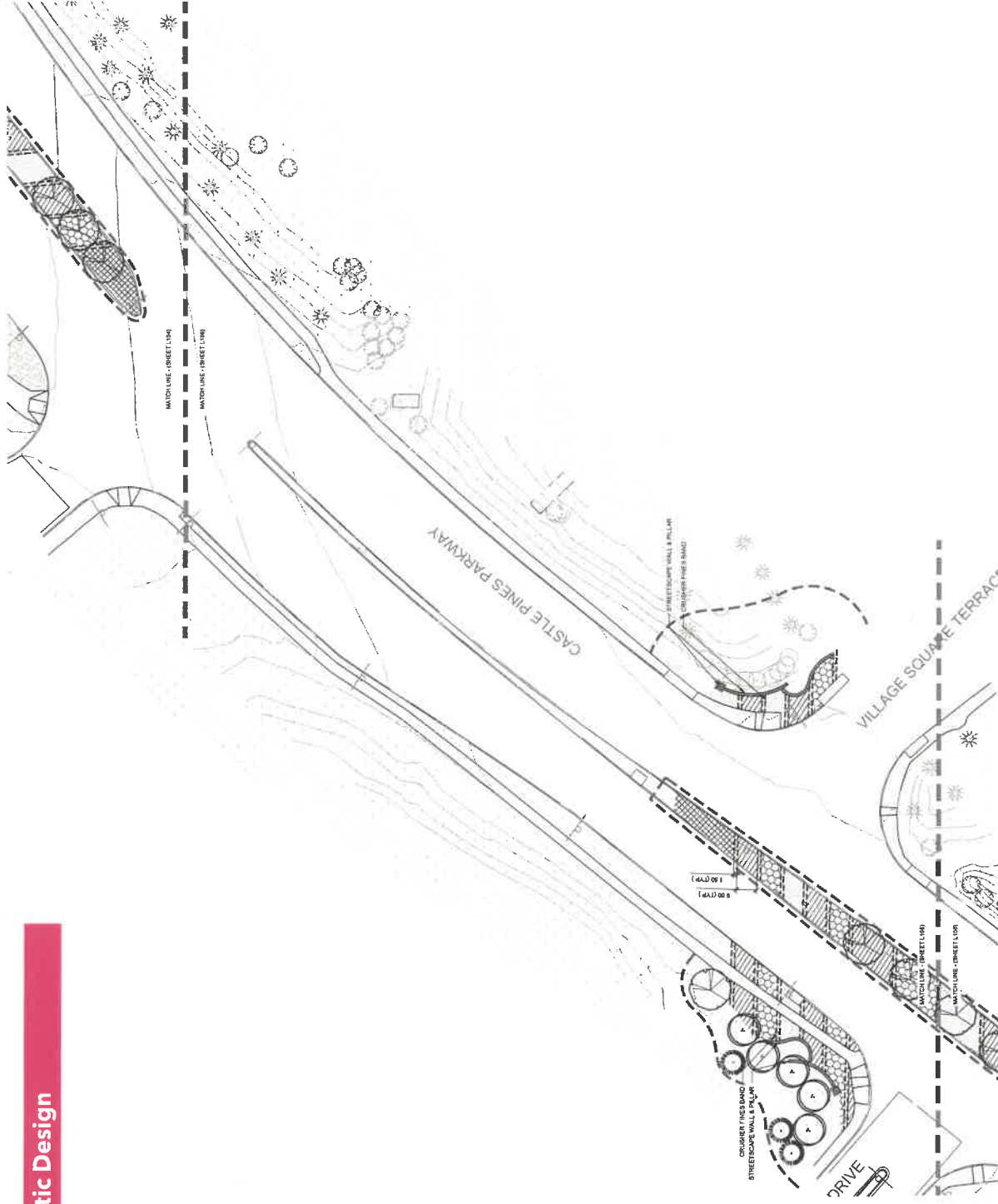

LAYOUT & GRADING LEGEND	
[Symbol]	LIMIT OF WORK
[Symbol]	PROPERTY BOUNDARY
[Symbol]	STEEL EDGER
[Symbol]	LOT LINES
[Symbol]	BASEMENT LINE
[Symbol]	MATCHLINE (SEE KEY MAP)
[Symbol]	CONCRETE WALK
[Symbol]	CRUISER FINES
[Symbol]	LANDSCAPE WALL
[Symbol]	MONUMENT PILLAR

LANDSCAPE LEGEND	
[Symbol]	EVERGREEN SHRUB
[Symbol]	DECIDUOUS SHRUB
[Symbol]	ORNAMENTAL GRASS
[Symbol]	PERENNIAL & GROUNDCOVER
[Symbol]	MANICURED TURF
[Symbol]	EXISTING TREES & SHRUBS
[Symbol]	PROPOSED TREES (DECIDUOUS ORN. EVO)

NOTE: SEE LANDSCAPE GENERAL NOTES SHEET FOR A LIST OF ABBREVIATIONS

BY OTHERS - N.I.C.	
[Symbol]	FIRE HYDRANT
[Symbol]	AREA INLET / DRAINAGE
[Symbol]	EXISTING T CONTOUR
[Symbol]	EXISTING S CONTOUR
[Symbol]	WATER VALVE
[Symbol]	TELEPHONE LINE
[Symbol]	ELECTRICAL LINE
[Symbol]	STOP LIGHT
[Symbol]	SIGN
[Symbol]	STREET LIGHT
[Symbol]	CONCRETE PAD
[Symbol]	SEWER MANHOLE
[Symbol]	MANHOLE
[Symbol]	EXISTING ELECTRICAL UTILITIES

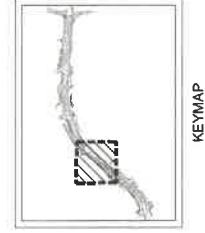

Castle Pines Parkway I.D. 2018-12-14-10-42-AM-DWG-COMMUNITY

Schematic Design

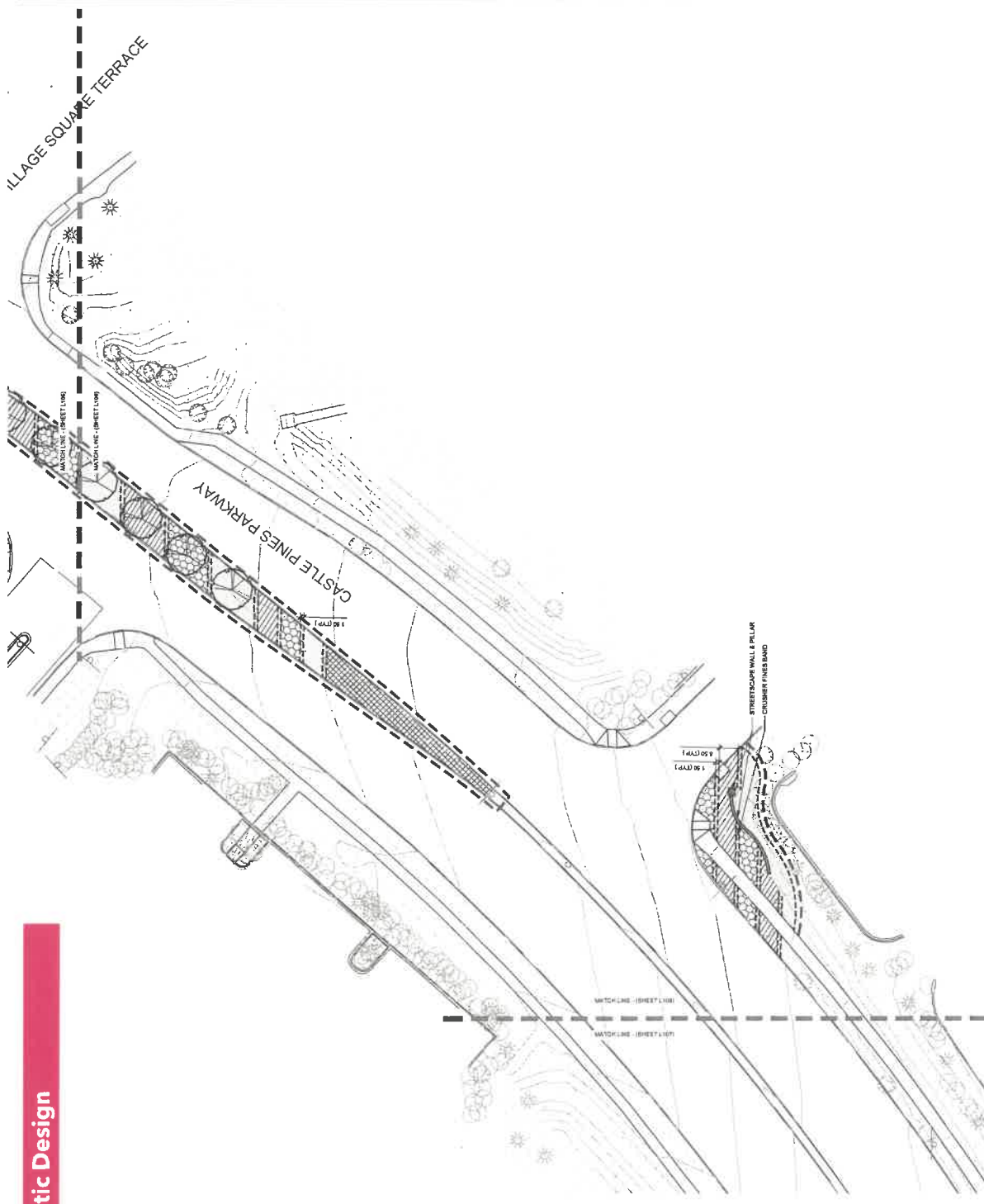

LAYOUT & GRADING LEGEND	
	LIMIT OF WORK
	PROPERTY BOUNDARY
	STEEL EDDGER
	LOT LINES
	EASEMENT LINE
	MATCHLINE (SEE KEY MAP)
	CONCRETE WALK
	CRUSHER FINES
	LANDSCAPE WALL
	MONUMENT PILLAR
LANDSCAPE LEGEND	
	EVERGREEN SHRUB
	DECIDUOUS SHRUB
	ORNAMENTAL GRASS
	PERENNIAL & GROUNDCOVER
	MANICURED TURF
	EXISTING TREES & SHRUBS
	PROPOSED TREES (DIAGONAL ORN. SW)

NOTE: SEE LANDSCAPE GENERAL NOTES SHEET FOR A LIST OF ABBREVIATIONS

BY OTHERS - N.I.C.	
	FIRE HYDRANT
	AREA INLET / DRAINAGE
	EXISTING 1" CONTOUR
	EXISTING 2" CONTOUR
	WATER VALVE
	TELEPHONE LINE
	ELECTRICAL LINE
	STOP LIGHT
	SIGN
	STREET LIGHT
	CONCRETE PAD
	SEWER MANHOLE
	MANHOLE
	EXISTING ELECTRICAL UTILITIES
TL	EM
PL	BE
EA	EE

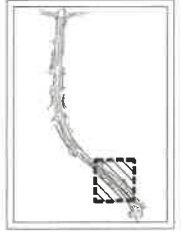

NOT FOR REGULATION. APPROVAL, PERMITS, OR CONSTRUCTION.

Schematic Design



LAYOUT & GRADING LEGEND

- LIMIT OF WORK
- PROPERTY BOUNDARY
- STEEL EDGE
- LOT LINES
- EASEMENT LINE
- MATCHLINE (SEE KEY MAP)
- CONCRETE WALK
- CRUISER PINES
- LANDSCAPE WALL
- MONUMENT PALAR

LANDSCAPE LEGEND

- EVERGREEN SHRUB
- DECIDUOUS SHRUB
- ORNAMENTAL GRASS
- PERENNIAL & GROUNDCOVER
- MANICURED TURF
- EXISTING TREES & SHRUBS
- PROPOSED TREES (ODD/DISEASE ORNL EVO)

NOTE: SEE LANDSCAPE GENERAL NOTES SHEET FOR A LIST OF ABBREVIATIONS

BY OTHERS - N.I.C.

- FIRE HYDRANT
- AREA INLET / DRAINAGE
- EXISTING 1" CONTOUR
- EXISTING 5" CONTOUR
- WATER VALVE
- TELEPHONE LINE
- ELECTRICAL LINE
- STOP LIGHT
- STREET LIGHT
- CONCRETE PAD
- SEWER MANHOLE
- MANHOLE
- EXISTING ELECTRICAL UTILITIES

Legend symbols: ERI, EM, FB, TL, TB, E



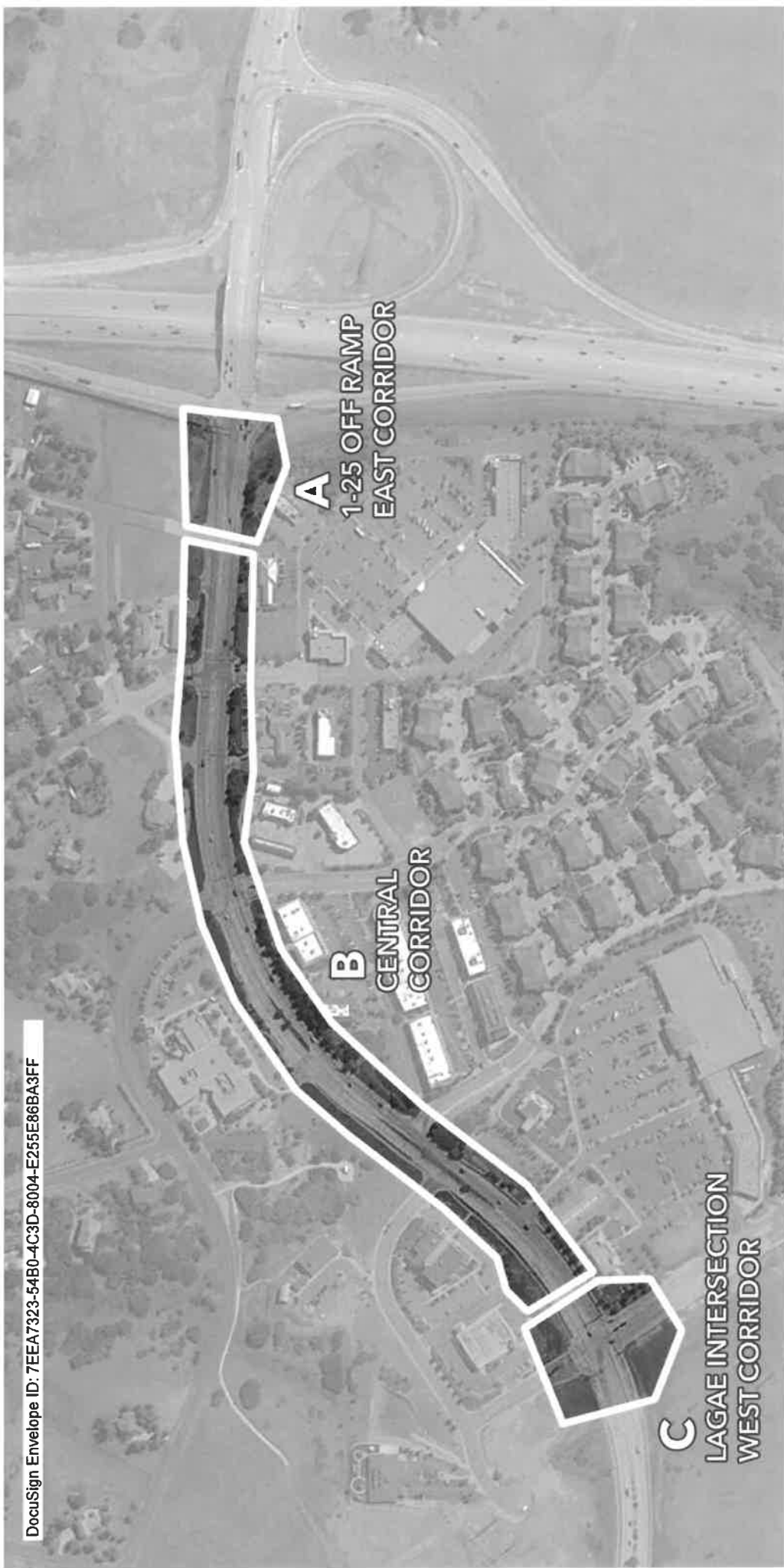

A
1-25 OFF RAMP
EAST CORRIDOR

B
CENTRAL
CORRIDOR

C
LAGAE INTERSECTION
WEST CORRIDOR

CITY OF CASTLE PINES
 Castle Pines Parkway
 Gateway Entrance Monumentation - Preliminary Construction Pricing
 7/5/2021

A - I-25 OFF RAMP EAST CORRIDOR

I-25 Off Ramp Primary Monumentation						
Item	Unit Qty	Unit	Unit Cost	Base-Total	Extended Cost	Total
Retaining Wall: Masonville Buff Sandstone, including foundation - Colloidal Backfill	233	SFF	\$ 98.00	\$ 22,834.00		\$ 22,834.00
Excavation	52	CY	\$ 50.00	\$ 2,600.00		\$ 2,600.00
4'-6" Monument Pillar (ht. varies), including foundation & footing	2	EA	\$ 15,000.00	\$ 30,000.00		\$ 30,000.00
Monument Pillar - Chip Logo Panel	2	EA	\$ 424.85	\$ 849.70		\$ 849.70
Monument Pillar Lantern (complete with electrical)	2	EA	\$ 10,178.80	\$ 20,357.60		\$ 20,357.60
Monument Signage Installation/inspection fees	1	LS	\$ 2,830.00	\$ 2,830.00		\$ 2,830.00
Crusher Fine Hardscape Bands (incl. steel edger)	259	SF	\$ 6.00	\$ 1,518.00		\$ 1,518.00
Permitting Acquisition (sign fabrication & installation)	1	LS	\$ 285.38	\$ 285.38		\$ 285.38
Existing Sign Relocation	1	LS	\$ 500.00	\$ 500.00		\$ 500.00
Deciduous Tree - 2.5" cal.	2	EA	\$ 600.00	\$ 1,200.00		\$ 1,200.00
Ornamental Tree - 2.5" cal.	6	EA	\$ 600.00	\$ 3,600.00		\$ 3,600.00
Evergreen Tree - 10'	12	EA	\$ 900.00	\$ 10,800.00		\$ 10,800.00
Shrub Bed (Incl. shrubs, soil prep, fabric, edger, mulch & irrigation)	2,273	SF	\$ 12.00	\$ 27,276.00		\$ 27,276.00
Manicured Turf - Sod	3,655	SF	\$ 0.58	\$ 2,119.90		\$ 2,119.90
Manicured Turf Irrigation	3,655	SF	\$ 1.60	\$ 5,848.00		\$ 5,848.00
Fine Grading	5,928	SF	\$ 0.07	\$ 414.96		\$ 414.96
Sub-Total						\$ 133,033.54

I-25 Off Ramp Median						
Item	Unit Qty	Unit	Unit Cost	Base-Total	Extended Cost	Total
Angled Spray Guard along median	1020	SF	\$ 14.00	\$ 14,280.00		\$ 14,280.00
Crusher Fine Hardscape Bands (incl. steel edger)	283	SF	\$ 6.00	\$ 1,698.00		\$ 1,698.00
Deciduous Tree - 2.5" cal.	4	EA	\$ 600.00	\$ 2,400.00		\$ 2,400.00
Shrub Bed (Incl. shrubs, soil prep, fabric, edger, mulch & irrigation)	4,029	SF	\$ 12.00	\$ 48,348.00		\$ 48,348.00
Sub-Total						\$ 66,726.00

I-25 Off Ramp Secondary Monumentation						
Item	Unit Qty	Unit	Unit Cost	Base-Total	Extended Cost	Total
Retaining Wall: Masonville Buff Sandstone, including foundation - Colloidal Backfill	128	SFF	\$ 98.00	\$ 12,544.00		\$ 12,544.00
Excavation	29	CY	\$ 50.00	\$ 1,450.00		\$ 1,450.00
4'-6" Monument Pillar (ht. varies), including foundation & footing	1	EA	\$ 15,000.00	\$ 15,000.00		\$ 15,000.00
Monument Pillar - Chip Logo Panel	1	EA	\$ 424.85	\$ 424.85		\$ 424.85
Monument Pillar Lantern (complete with electrical)	1	EA	\$ 10,178.80	\$ 10,178.80		\$ 10,178.80
Monument Signage Installation/inspection fees	1	LS	\$ 1,730.00	\$ 1,730.00		\$ 1,730.00
Crusher Fine Hardscape Bands (incl. steel edger)	174	SF	\$ 6.00	\$ 1,044.00		\$ 1,044.00
Permitting Acquisition (sign fabrication & installation)	1	LS	\$ 285.38	\$ 285.38		\$ 285.38
Concrete Walkway (incl. 5' width walkway, 4" depth)	3,200	SF	\$ 5.00	\$ 16,000.00		\$ 16,000.00
Deciduous Tree - 2.5" cal.	3	EA	\$ 600.00	\$ 1,800.00		\$ 1,800.00
Ornamental Tree - 2.5" cal.	0	EA	\$ 600.00	\$ -		\$ -
Evergreen Tree - 10'	2	EA	\$ 900.00	\$ 1,800.00		\$ 1,800.00
Shrub Bed (Incl. shrubs, soil prep, fabric, edger, mulch & irrigation)	1,576	SF	\$ 12.00	\$ 18,912.00		\$ 18,912.00
Manicured Turf - Seed	0	SF	\$ 0.22	\$ -		\$ -
Fine Grading	1,576	SF	\$ 0.07	\$ 110.32		\$ 110.32
Sub-Total						\$ 81,279.35

Overall Sitework & General Conditions						
Item	Unit Qty	Unit	Unit Cost	Base-Total	Extended Cost	Total
Rough Grading +/- 3'	7,504	SF	\$ 0.21	\$ 1,575.84		\$ 1,575.84
Mobilization/Subcontractor Mobilization	4.0%	LS	\$ 11,241.56	\$ 11,241.56		\$ 11,241.56
General Conditions	9.4%	LS	\$ 26,417.66	\$ 26,417.66		\$ 26,417.66
Landscape - 1 yr. Warranty/1 yr. Maintenance	1	LS	\$ 4,497.87	\$ 4,497.87		\$ 4,497.87
Survey/Layout	1	LS	\$ 3,000.00	\$ 3,000.00		\$ 3,000.00
Sub-Total						\$ 46,732.92

Total						\$ 327,771.81
Contingency 20%						\$ 65,554.36
Grand Total						\$ 393,326.17

Note:
 These are generally accepted costs as of the conceptual project completion in 2020, and should not be relied upon for final budgeting purposes.

Exclusions (N.I.C.):
 1. Lighting/Electrical
 2. CDOT Costs
 3. Cost of Water & Water Taps

CITY OF CASTLE PINES
 Castle Pines Parkway
 Gateway Entrance Monumentation - Preliminary Construction Pricing
 2/5/2021

B - CENTRAL CORRIDOR

Central Corridor Monumentation + Landscape						
Item	Unit Qty	Unit	Unit Cost	Base-Total	Extended Cost	Total
Retaining Wall: Masonville Buff Sandstone, Including foundation - Colloidal Backfill	784	SFF	\$ 98.00	\$ 76,832.00		\$ 76,832.00
Excavation	176	CY	\$ 50.00	\$ 8,800.00		\$ 8,800.00
4'-6" Monument Pillar (ht. varies), including foundation & footing	5	EA	\$ 15,000.00	\$ 75,000.00		\$ 75,000.00
Monument Pillar - Chip Logo Panel	5	EA	\$ 424.85	\$ 2,124.25		\$ 2,124.25
Monument Pillar Lantern (complete with electrical)	5	EA	\$ 10,178.80	\$ 50,894.00		\$ 50,894.00
Monument Signage Installation/inspection fees	1	LS	\$ 6,280.00	\$ 6,280.00		\$ 6,280.00
Crusher Fine Hardscape Bands (incl. steel edger)	1090	SF	\$ 6.00	\$ 6,540.00		\$ 6,540.00
Permitting Acquisition (sign fabrication & installation)	1	LS	\$ 285.38	\$ 285.38		\$ 285.38
Deciduous Tree - 2.5" cal.	4	EA	\$ 600.00	\$ 2,400.00		\$ 2,400.00
Ornamental Tree - 2.5" cal.	12	EA	\$ 600.00	\$ 7,200.00		\$ 7,200.00
Evergreen Tree - 10"	6	EA	\$ 900.00	\$ 5,400.00		\$ 5,400.00
Shrub Bed (incl. shrubs, soil prep, fabric, edger, mulch & Irrigation)	9,832	SF	\$ 12.00	\$ 117,984.00		\$ 117,984.00
Manicured Turf - Sod	0	SF	\$ 0.58	\$ -		\$ -
Fine Grading	9,832	SF	\$ 0.07	\$ 688.24		\$ 688.24
Sub-Total						\$ 360,067.87

Central Corridor Median						
Item	Unit Qty	Unit	Unit Cost	Base-Total	Extended Cost	Total
Crusher Fine Hardscape Bands (incl. steel edger)	470	SF	\$ 6.00	\$ 2,820.00		\$ 2,820.00
Deciduous Tree - 2.5" cal.	11	EA	\$ 600.00	\$ 6,600.00		\$ 6,600.00
Shrub Bed (incl. shrubs, soil prep, fabric, edger, mulch & Irrigation)	6,140	SF	\$ 12.00	\$ 73,680.00		\$ 73,680.00
Sub-Total						\$ 83,100.00

Overall Sitework & General Conditions						
Item	Unit Qty	Unit	Unit Cost	Base-Total	Extended Cost	Total
Rough Grading +/- 3'	9,832	SF	\$ 0.21	\$ 2,064.72		\$ 2,064.72
Mobilization/Subcontractor Mobilization	4.0%	LS	\$ 17,726.71	\$ 17,726.71		\$ 17,726.71
General Conditions	9.4%	LS	\$ 41,657.78	\$ 41,657.78		\$ 41,657.78
Landscape - 1 yr. Warranty/1 yr. Maintenance	1	LS	\$ 8,784.60	\$ 8,784.60		\$ 8,784.60
Survey/Layout	1	LS	\$ 5,000.00	\$ 5,000.00		\$ 5,000.00
Sub-Total						\$ 75,233.81

Total		\$ 518,401.68
Contingency 20%		\$ 103,680.34
Grand Total		\$ 622,082.02

Note:
 These are generally accepted costs as of the conceptual project completion in 2020, and should not be relied upon for final budgeting purposes.

Exclusions (N.I.C.):
 1. Lighting/Electrical
 2. CDOT Costs
 3. Cost of Water & Water Taps

CITY OF CASTLE PINES
 Castle Pines Parkway
 Gateway Entrance Monumentation - Preliminary Construction Pricing
 2/5/2021

C - LAGAE INTERSECTION WEST CORRIDOR

Lagae Monumentation + Landscape						
Item	Unit Qty	Unit	Unit Cost	Base-Total	Extended Cost	Total
Retaining Wall: Masonville Buff Sandstone, including foundation - Colloidal Backfill	524	SFF	\$ 98.00	\$ 51,352.00		\$ 51,352.00
Excavation	118	CY	\$ 50.00	\$ 5,900.00		\$ 5,900.00
4'-6" Monument Pillar (ht. varies), including foundation & footing	4	EA	\$ 15,000.00	\$ 60,000.00		\$ 60,000.00
Monument Pillar - Chip Logo Panel	4	EA	\$ 424.85	\$ 1,699.40		\$ 1,699.40
Monument Pillar Lantern (complete with electrical)	4	EA	\$ 10,178.80	\$ 40,715.20		\$ 40,715.20
Monument Signage Installation/Inspection fees	1	LS	\$ 5,130.00	\$ 5,130.00		\$ 5,130.00
Crusher Fine Hardscape Bands (incl. steel edger)	1423	SF	\$ 6.00	\$ 8,538.00		\$ 8,538.00
Permitting Acquisition (sign fabrication & installation)	1	LS	\$ 285.38	\$ 285.38		\$ 285.38
Deciduous Tree - 2.5" cal.	4	EA	\$ 600.00	\$ 2,400.00		\$ 2,400.00
Ornamental Tree - 2.5" cal.	12	EA	\$ 600.00	\$ 7,200.00		\$ 7,200.00
Evergreen Tree - 10'	12	EA	\$ 900.00	\$ 10,800.00		\$ 10,800.00
Shrub Bed (incl. shrubs, soil prep, fabric, edger, mulch & irrigation)	12,517	SF	\$ 12.00	\$ 150,204.00		\$ 150,204.00
Maintured Turf - Sod	0	SF	\$ 0.58	\$ -		\$ -
Fine Grading	12,517	SF	\$ 0.07	\$ 876.19		\$ 876.19
Sub-Total						\$ 345,100.17

Overall Sitework & General Conditions						
Item	Unit Qty	Unit	Unit Cost	Base-Total	Extended Cost	Total
Rough Grading +/- .3'	12,517	SF	\$ 0.21	\$ 2,628.57		\$ 2,628.57
Mobilization/Subcontractor Mobilization	4.0%	LS	\$ 13,804.01	\$ 13,804.01		\$ 13,804.01
General Conditions	9.4%	LS	\$ 32,439.42	\$ 32,439.42		\$ 32,439.42
Landscape - 1 yr. Warranty/1 yr. Maintenance	1	LS	\$ 4,881.63	\$ 4,881.63		\$ 4,881.63
Survey/Layout	1	LS	\$ 3,000.00	\$ 3,000.00		\$ 3,000.00
Sub-Total						\$ 56,753.62

Total	\$ 401,853.79
Contingency 20%	\$ 80,370.76
Grand Total	\$ 482,224.55

Note:
 These are generally accepted costs as of the conceptual project completion in 2020, and should not be relied upon for final budgeting purposes.

Exclusions (N.I.C.):
 1. Lighting/Electrical
 2. CDDT Costs
 3. Cost of Water & Water Tap